

Vision Sensor

VDS20 Series



NEW!

Basic Features	Operating Principle	Intelligent Vision Sensor		
	Shell Style	Square		
	Detection Range	100~2000mm		
	Field of View	-		
	Focal Length	8mm	12mm	16mm
	Focus Adjustment Method	Mechanical Focus		
	Resolution	30fps		
	Light Source	2600*1952		
	Color/Black and White	Standard white light / High brightness white light		
	Shutter	Color		
	Indicator Light	Global		
	Algorithms / Tools	Integrated AI algorithm, by learning a small number of samples, can complete ORC and classification and other visual inspection applications, support one-click adjustment of parameters, automatically complete focus, exposure, automatic adjustment work, Provides red/white light source optional, 4 groups of independently controlled light sources, 16 fill light solutions, and polarized light source		
		Positioning: Position correction		
		Presence: Pattern, spots, edges, circles		
Counting: pattern counting, spot counting, edge counting				
Detection: width detection, spot detection, color area				
Identification: character recognition, code reading, classification				
Electrical data	Logic: logical reasoning, numerical ranking			
	Image Sensor Size	1 green light spot indicates the center area of scanning position; 5 status LEDs and buzzer		
	Target Surface Size	2.2μm x 2.2μm		
	Maximum Reading Speed	1/2.5"		
	Exposure Time	20μs~100ms		
	Gain	-		
	Operating Voltage	24V DC		
	Power Consumption	15W		
	Output Type	Two optically isolated inputs, supporting NPN, PNP types; three non-isolated outputs		
	Communication Protocol	TCP Server, TCP Client, ModBus TCP, ModBus RTU, Profinet, Ethernet/IP, MELSEC/SLMP, Serial		
Communication Interface	RS232, Ethernet			
Environmental conditions	Operating Temperature	0~45°C		
	Storage Temperature	-20~70°C		
	Humidity	5%~95% RH		
	Protection Level	IP67		
	Connection Method	Cable Connection		
Mechanical data	Dimensions	58*53.5*69mm(Standard Light source), 75.1*65.5*91.6mm(High Brightness Light source)		
	Weight	220g(Standard Light source), 380g(High Brightness Light source)		
	Accessories	M12-12PIN-3M(3M high flexibility) dedicated network cable; M12-8PIN-3M(3M high flexibility) dedicated data cable; L-shaped mounting bracket, screwdriver		
	Optional	M12-8PIN-5M(5M high flexibility) dedicated network cable; M12-8PIN-10M(10M high flexibility) dedicated network cable M12-12PIN-5M(5M high flexibility) dedicated data cable; M12-12PIN-10M(10M high flexibility) dedicated data cable		
Model	Non-polarized standard white light	VDS20C-X508WP	VDS20C-X512WP	VDS20C-X516WP
	Semi-polarized standard white light	VDS20C-X508WD	VDS20C-X512WD	VDS20C-X516WD
	Non-polarized High Brightness white light	VDS20C-X508WH	VDS20C-X512WH	VDS20C-X516WH
	Semi-polarized High Brightness white light	VDS20C-X508WHD	VDS20C-X512WHD	VDS20C-X516WHD

Unit: mm

Standard Light source

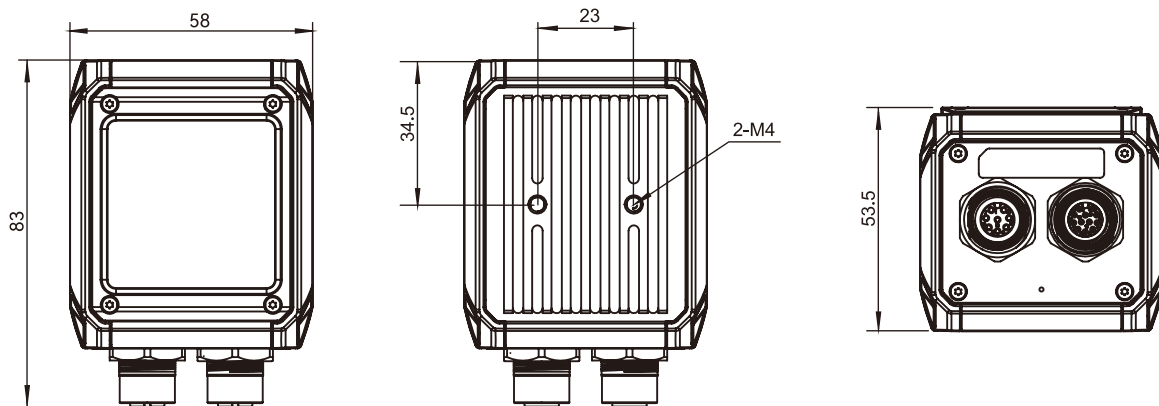

High Brightness Light source

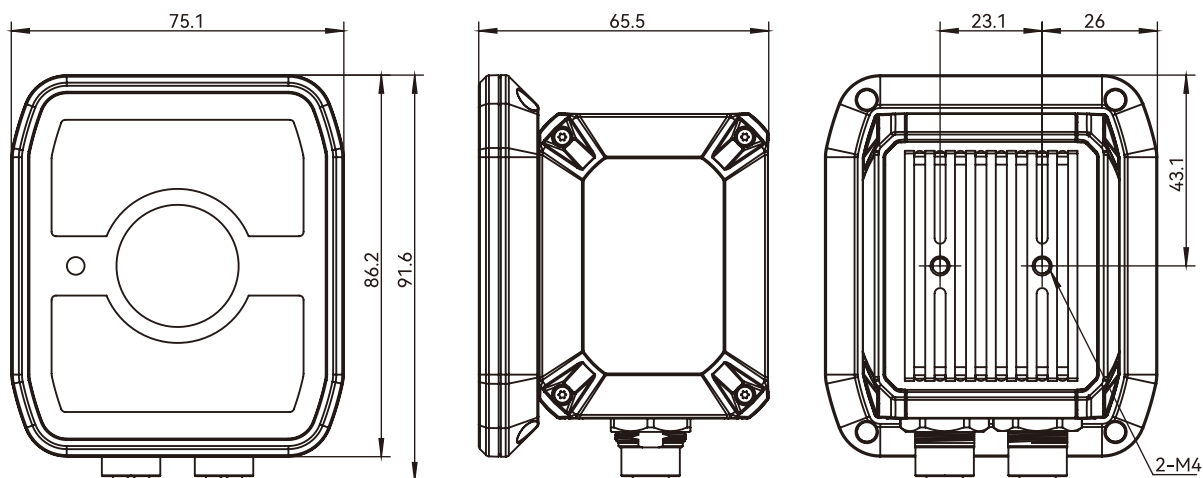

- Fiber Optic
- Slot Sensors
- Photoelectric
- Laser
- Proximity
- Displacement
- Magnetic
- Contact
- Area
- Ultrasonic
- AI Image**
- Code Readers
- Vibration
- Temperature
- RFID
- Safety doorlock
- Pressure Switch
- Communication
- Accessories

Guidance

Vision Camera

AKUSENSE AIVS

Vision Sensors