

Cylindrical Type

M18 Short-body Series



Ultrasonic

Basic Features	Operating Principle	Ultrasonic Detection		
	Enclosure Shape	Cylindrical		
	Detection Method	Diffuse reflection		
	Detection Range	40~300mm	60~800mm	
	Divergence Angle	7°±2°	8°±2°	
	Resolution	2mm		
	Detection Range Adjustment	External teaching		
Electrical data	Output Mode	0~10V / 4~20mA / NPN / PNP	0~10V / 4~20mA / NPN / PNP	
	Response Time	Switch output 12ms, Analog output 500ms	Switch output 80ms, Analog output 500ms	
	Switching Frequency	8Hz	5Hz	
	Repeatability	2%		
	Hysteresis	2%		
	Operating Voltage	15~30VDC		
	Operating Current	≤35mA		
	Residual Voltage	2.2Vmax(1L=100mA)		
	Load Current	≤100mA		
	Maximum Ripple	±5%		
	Voltage Drop	≤2.2V(100mA)		
	Protection Circuit	Reverse polarity protection/short circuit protection (auto reset)/surge protection		
	Temperature Drift	5%		
	Temperature Compensation	Have		
	Environmental conditions	Working Temperature	-20~70°C	
Protect Degree		IP67		
Mechanical data	Connection Method	M12/4-pin connector		
	Maximum Tightening Torque	1Nm		
	Dimensions	M18x60.4mm		
	Material	PBT		
	Weight	0.015kg		
	Accessories	Plastic nut M18x1		
Model	Analog	Voltage	MS18-30V	MS18-90V
		Current	MS18-30I	MS18-90I
	Switch	NPN	MS18-30N	MS18-90N
		PNP	MS18-30P	MS18-90P

Fiber Optic
Slot Sensors
Photoelectric
Laser
Proximity
Displacement
Magnetic
Contact
Area
Ultrasonic
AI Image
Code Readers
Vibration
Temperature
RFID
Safety door lock
Pressure Switch
Communication
Accessories

Guidance

Ultrasonic

Cylindrical type

Solid level switches type

Fork level switch typ

Double-sheet sensor

Dimensions

Unit: mm

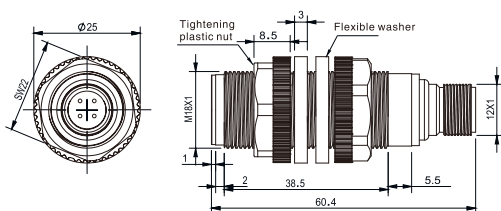

Wiring Diagram

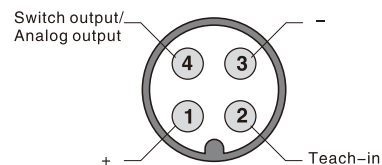

Cylindrical Type

M18 Plastic Housing Series



Basic Features	Operating Principle	Ultrasonic Detection				
	Enclosure Shape	Cylindrical				
	Detection Method	Diffuse reflection				
	Detection Range	50~400mm	100~900mm	150~1600mm	200~2200mm	
	Divergence Angle	± 8°	± 7°	± 8°	± 7°	
	Resolution	3mm	2mm	3mm		
	Detection Range Adjustment	-				
Electrical data	Output Mode	0~10V / 4~20mA / NPN / PNP	0~10V / 4~20mA / NPN / PNP	0~10V / 4~20mA / NPN / PNP	0~10V / 4~20mA / NPN / PNP	
	Response Time	500ms	≤ 125ms	≤ 250ms	≤ 500ms	
	Switching Frequency	10Hz	4Hz	2Hz	1Hz	
	Repeatability	0.5%				
	Hysteresis	1%				
	Operating Voltage	15~30VDC				
	Operating Current	≤ 50mA				
	Residual Voltage	2.2V max. (1L=100mA)				
	Load Current	≤ 100mA				
	Maximum Ripple	± 5%				
	Voltage Drop	≤ 2.2V(100mA)				
	Protection Circuit	Reverse Polarity Protection/Short-circuit (Auto-reset)/Pulse Overvoltage Protection				
	Temperature Drift	5%				
	Temperature Compensation	Have				
	Environmental conditions	Working Temperature	-20~60°C			
Protect Degree		IP67				
Mechanical data	Connection Method	M12/4-pin connector				
	Maximum Tightening Torque	50Nm				
	Dimensions	M18x91.5mm				
	Material	PBT				
	Weight	0.026kg				
	Accessories	Plastic nut M18x1				
Model	Analog	Voltage	MC18-40V	MC18-90V	MC18-160V	MC18-220V
		Current	MC18-40I	MC18-90I	MC18-160I	MC18-220I
	Switch	NPN	MC18-40N	MC18-90N	MC18-160N	MC18-220N
		PNP	MC18-40P	MC18-90P	MC18-160P	MC18-220P

Dimensions

Unit: mm

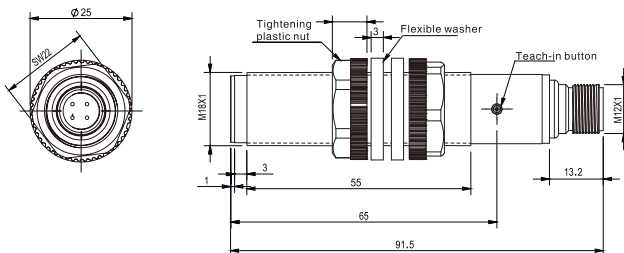

Wiring Diagram

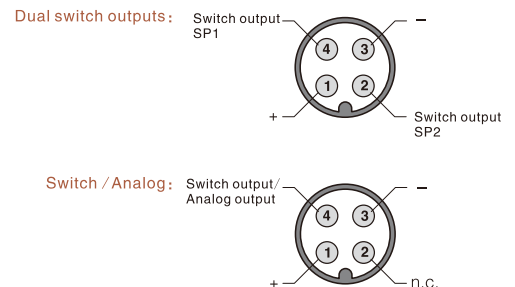



Basic Features	Operating Principle	Ultrasonic Detection	
	Enclosure Shape	Cylindrical	
	Detection Method	Diffuse reflection	
	Detection Range	60~1000mm	
	Divergence Angle	± 7°	
	Resolution	0.5mm	
	Ultrasonic Frequency	200kHz	
	Detection Range Adjustment	-	
	Indicator	When no target is detected, the learning status LED remains lit: red LED; when a target is detected, it blinks in learning mode: blue LED; operational mode: yellow LED; power on: green LED	
Electrical data	Output Mode	0~5V / 0~10V / 4~20mA / NPN / NPN Hysteresis Mode / PNP / PNP Hysteresis Mode	
	Response Time	100ms	
	Switching Frequency	5Hz	
	Repeatability	0.3%	
	Linearity	< 1%	
	Operating Voltage	9~30VDC	
	Operating Current	≤25mA	
	Residual Voltage	≤10μA(30VDC)	
	Load Current	≤200mA	
	Maximum Ripple	±10%	
	Insulation Resistance	-	
	Protection Circuit	Reverse Connection Protection/Transient Overvoltage Protection	
	Temperature Drift	0.05%/°C	
	Temperature Compensation	Have	
Environmental conditions	Working Temperature	-20~70°C	
	Protect Degree	IP65	
Mechanical data	Connection Method	V3 Connector, 4 Pins	
	Maximum Tightening Torque	50Nm	
	Dimensions	M18x90.7mm	
	Material	Nickel-Copper Plating	
	Weight	0.062kg	
	Accessories	Nut M18x1	
Model	Analog	Voltage Output 0~5V	MT18-100V
		Voltage Output 0~10V	MT18-100V2
		Current Output 4~20mA	MT18-100A
	Switch	NPN	MT18-100N
		NPN Hysteresis Mode	MT18-100N2
		PNP	MT18-100P
		PNP Hysteresis Mode	MT18-100P2
Numerical Capacity	TTL Output	MT18-100T	

Fiber Optic

Slot Sensors

Photoelectric

Laser

Proximity

Displacement

Magnetic

Contact

Area

Ultrasonic

AI Image

Code Readers

Vibration

Temperature

RFID

Safety door lock

Pressure Switch

Communication

Accessories

Guidance

Ultrasonic

Cylindrical type

Solid level switches type

Fork level switch typ

Double-sheet sensor

Cylindrical Type

M18 Metal Housing Series

Dimensions

Unit: mm

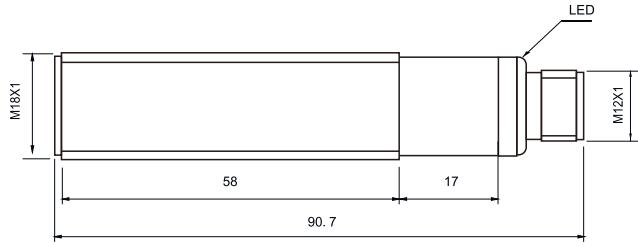

Circuit Diagram

TTL output

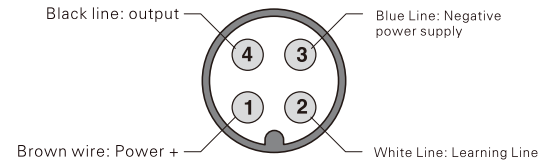

Other output

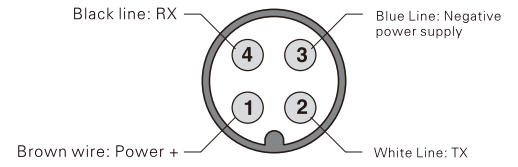

Fiber Optic

Slot Sensors

Photoelectric

Laser

Proximity

Displacement

Magnetic

Contact

Area

Ultrasonic

AI Image

Code Readers

Vibration

Temperature

RFID

Safety door lock

Pressure Switch

Communication

Accessories

Guidance

Ultrasonic

Cylindrical type

Solid level switches type

Fork level switch typ

Double-sheet sensor



Basic Features	Operating Principle	Ultrasonic Detection	
	Enclosure Shape	Cylindrical	
	Detection Method	Diffuse reflection	
	Detection Range	50~400mm	
	Divergence Angle	≤12°	
	Resolution	0.1mm	
	Ultrasonic Frequency	300kHz	
	Detection Range Adjustment	Teach Button	
	Indicator	Operational/Error Mode: LED; Switch Status: LED	
Electrical data	Output Mode	NPN+0~10V	
	Response Time	25ms	
	Switching Frequency	20Hz	
	Repeatability	1mm	
	Hysteresis	2mm	
	Operating Voltage	18~30VDC	
	Operating Current	≤30mA	
	Residual Voltage	≤10μA(30VDC)	
	Load Current	≤100mA	
	Voltage Drop	≤2.2V(100mA)	
	Protection Circuit	Short-circuit Protection/Reverse Polarity Protection/Overload Protection	
	Temperature Compensation	None	
	Environmental conditions	Working Temperature	-25~60°C
		Protect Degree	IP67
Mechanical data	Connection Method	M12/5-Pin Connector	
	Maximum Tightening Torque	-	
	Dimensions	M18x86.0mm	
	Material	Stainless steel	
	Weight	0.062kg	
	Accessories	Nut M18x1	
	Model	MD18-35V	

- Fiber Optic
- Slot Sensors
- Photoelectric
- Laser
- Proximity
- Displacement
- Magnetic
- Contact
- Area
- Ultrasonic**
- AI Image
- Code Readers
- Vibration
- Temperature
- RFID
- Safety door lock
- Pressure Switch
- Communication
- Accessories

Guidance

Ultrasonic

Cylindrical type

Solid level switches type

Fork level switch typ

Double-sheet sensor

Dimensions

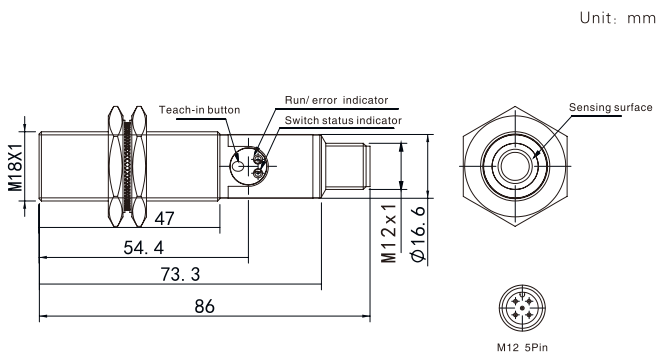

Wiring Diagram

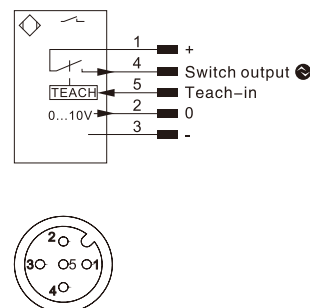

Cylindrical Type

M30 Series



Basic Features	Operating Principle	Ultrasonic Detection		
	Enclosure Shape	Cylindrical		
	Detection Method	Diffuse reflection		
	Detection Range	250~3500mm	350~6000mm	
	Divergence Angle	± 7°	± 9°	
	Resolution	4.0mm	6.0mm	
	Detection Range Adjustment	Teach Button		
Electrical data	Output Mode	Analog: 0~10V / 4~20mA, Switch: NPN / PNP, Dual-channel Digital Output: 2NPN / 2PNP Analog + switch: NPN+4~20mA / PNP+4~20mA / NPN+0~10V / PNP+0~10V		
	Response Time	Switch value 250ms, analog value 600ms	Switch value 500ms, analog value 600ms	
	Switching Frequency	2Hz	1Hz	
	Repeatability	1.0%	0.5%	
	Hysteresis	1%		
	Operating Voltage	12~30VDC, Analog voltage output: 15~30VDC(5%)		
	Operating Current	≤ 50mA		
	Residual Voltage	2.2V max. (1L=100mA)		
	Load Current	≤ 100mA		
	Maximum Ripple	± 5%		
	Voltage Drop	≤ 2.2V(100mA)		
	Protection Circuit	Reverse Polarity Protection/Short-circuit (Auto-reset)/Transient Overvoltage Protection		
	Temperature Drift	± 8% (switch output), ± 5% (analog output)		
	Temperature Compensation	Have		
	Environmental conditions	Working Temperature	-20~70°C	
Protect Degree		IP67		
Mechanical data	Connection Method	M12/4pin connector		
	Maximum Tightening Torque	1.5Nm		
	Dimensions	M30x102.0mm	M30x93.0mm	
	Material	PBT		
	Weight	0.14kg	0.17kg/0.17kg/0.14kg/0.14kg/0.14kg/0.14kg	
	Accessories	Nut M30x1.5		
Model	Analog	Voltage	MC30-350V	
		Current	MC30-350I	
	Switch	NPN	MC30-350N	
		PNP	MC30-350P	
	Dual-channel Digital Output	NPN	MC30-350N2	MC30-600N2
		PNP	MC30-350P2	MC30-600P2
	Analog + switch	NPN+Current	MC30-350NI	MC30-600NI
		PNP+Current	MC30-350PI	MC30-600PI
NPN+Voltage		MC30-350NV	MC30-600NV	
PNP+Voltage		MC30-350PV	MC30-600PV	

Dimensions

Unit: mm

MC30-350

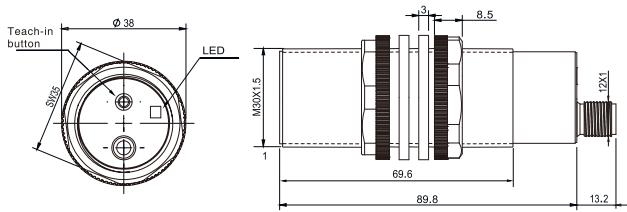

MC30-600

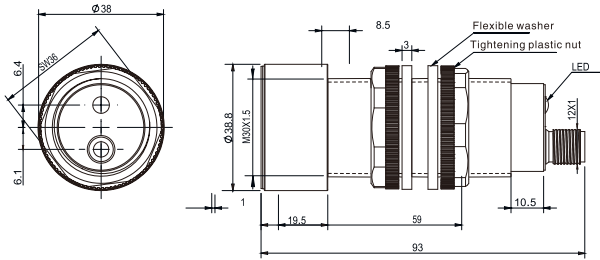

Wiring Diagram

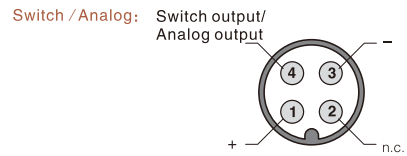
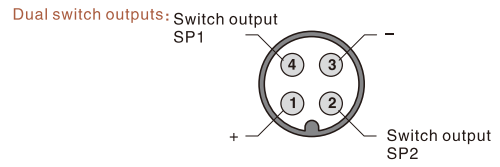
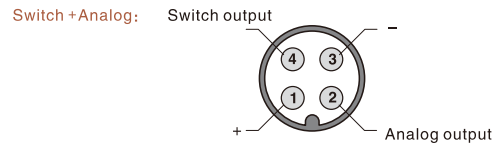

Fiber Optic

Slot Sensors

Photoelectric

Laser

Proximity

Displacement

Magnetic

Contact

Area

Ultrasonic

AI Image

Code Readers

Vibration

Temperature

RFID

Safety door lock

Pressure Switch

Communication

Accessories

Guidance

Ultrasonic

Cylindrical type

Solid level switches type

Fork level switch typ

Double-sheet sensor